

The background of the entire page is dark grey. It features several stylized, light grey line drawings of car wheels and speakers. In the top left, there is a crescent-shaped logo. The word "DIAMOND" is written in a large, bold, sans-serif font, with "AUDIO" in a smaller, spaced-out font directly beneath it.

DIAMOND
AUDIO

VSP4BMW

**BMW[®] Specific
4" Component Speakers Pair
Owners Manual**

ABOUT THE DIAMOND AUDIO EXPERIENCE

Congratulations, you have just purchased the finest mobile audio products on the market to date. At Diamond Audio, our products represent the latest advances in acoustic technology in sound reproduction for your vehicle. Diamond Audio products are designed, developed, and engineered using the latest innovative materials and components to provide the finest sound reproduction possible. Every Diamond Audio product has been Klippel verified and tested to ensure the best sounding and most reliable product on the market, if installed properly, Diamond Audio products will provide many years of the ultimate listening experience.

Please note that prolonged exposure to sound pressure levels in excess of 100dB can cause permanent hearing loss. Using Diamond Audio products can exceed that level so please exercise restraint in its operation in order to preserve your ability to enjoy its high fidelity sound for many years to come.

Diamond Audio recommends our products be professionally installed by an authorized Diamond Audio dealer to achieve the best possible system recommendation and installation. This will ensure a true Diamond Audio listening experience and sound you would expect from Diamond Audio products. In doing this you will extend your warranty from one year to two years.

Go ahead, Hear the Music

FEATURES

- BMW® Specific 2-Way 4" Component Speaker Set
- 4 Ohm Speaker load perfect for the Stock BMW amplifier
- 40W RMS/80W MAX Power Handling
- High-Strength Stamped Steel Frame With Integrated Terminals
- 20mm Silk Dome Tweeters
- Glass Fiber Reinforced Cone
- FEA Optimized High-Power Ferrite Motor Structure
- Milled Voice Coil Cooling Vents With Polished Backplate
- Separate Optimized Tweeter Crossover Module
- Klippel® Optimized Motor And Suspension Symmetry

4 " BMW Component Vehicle Compatibility List - By Series

3-SERIES 2005-2011

Coupe (E92) Front
Sedan (E90) Front, Rear
Touring (E91) Front, Rear
Cabrio (E93) Front

5-SERIES 2011-Current

Sedan (F10) Front, Rear
Touring (F11) Front, Rear
6-SERIES 2011-Current
Coupe (F13) Rear
Convertible (F12) Rear

7-SERIES 2008-Current

Limousine (F01) Front, Rear
X1 2009-2012
SUV (E84) Front

**THE COMPLETE LISTING OF ALL BMW AND MINIS THAT THE
4 INCH COMPONENT SPEAKER FITS IS ON PAGES 7, 8 AND 9**

DIMENSIONS AND SPECIFICATIONS

Specifications:	VSP4BMW
Total Diameter (A)	3.75inch/95mm
Mounting Depth(B)	1.32inch/33.5mm
Impedance	4 Ohm
Frequency response	80 – 20 KHz
SPL 1W/1M	85.6dB
Power Watt RMS	40
Power Watt Maximum	80
RE	3.2 Ohm
SPL	85.6 dB
FS	98 Hz
QMS	6.66
QES	0.67
QTS	0.60
VAS	1.65L / 0.56 cu.ft
Specifications:	TWEETER
Total Diameter (A)	1.68inch/42.8mm
Mounting Depth	0.59inch/13mm
Impedance	4 Ohm
Frequency response	1280– 20 KHz
SPL 1W/1M	92 dB
Power Watt RMS	40
Power Watt Maximum	80
RE	3.2 Ohm
FS	1280 Hz

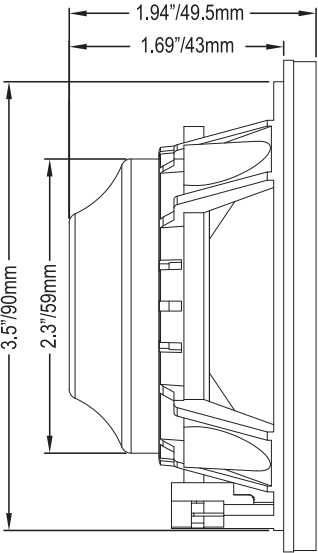
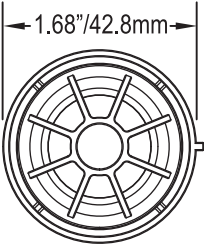
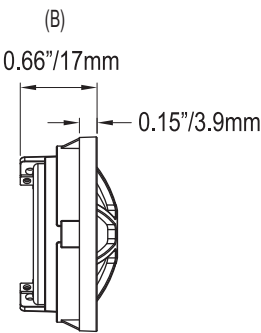

GENERAL SPEAKER INSTALLATION

General instructions for Diamond Audio BMW specific components. We ask that you read this manual in its entirety to prevent damage to the speakers and possible damage to your BMW. Read this manual carefully and follow all installation instructions. This product has been checked for proper function prior to shipping and is guaranteed against manufacturing defects. For a proper performance and to ensure full warranty coverage, we strongly recommend to get this product installed by an authorized Diamond Audio dealer. This will also increase your warranty from 1 year to 2 years.

General instruction for installing Diamond Audio BMW specific speaker systems. The method of installation chosen and level of execution will effect the overall performance of the speaker system. Treat each installation step with a high degree of attention. We strongly recommend that you do a "Pre-Check" of the wiring and speakers. This will allow a trial listening test before securing the loudspeakers into their mounting locations.

Install the speaker wiring in a manner which precludes any danger of the leads being exposed to tearing or crushing forces. If there are sharp edges in the vicinity (e.g. holes in the bodywork) all cables should be put thru a "grommet" to protect and prevent fraying. Make sure that all speaker wires easily reach the speaker terminals without stress on the wire or connectors. Once you have tested the complete speaker the audio system off and prepare the loudspeaker for final installation

TWEETER INSTALLATION

For the installation of the tweeters you have to re-move the mirror triangles that incorporated the original tweeters. Remove the original tweeters from the triangles and replace them with the new Diamond Audio tweeters. If you own a car that hasn't any tweeters installed, you have to buy the appropriate mirror triangles as spare parts from your BMW dealer. After the installation of the midwoofers and the tweeters you have to connect them to the crossover network using the included cable harness. Please note that all wires from speaker to crossover network are already pre-assembled with cable shoes

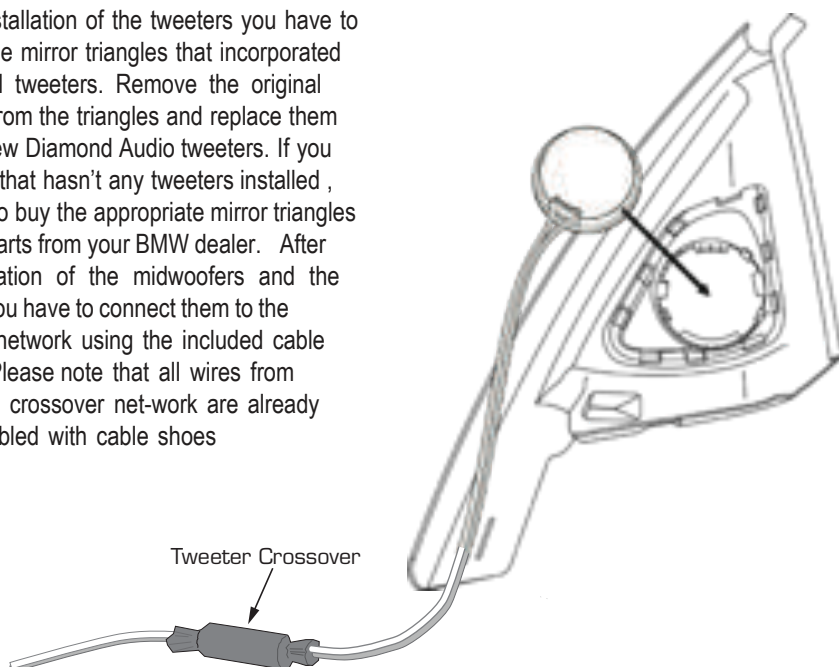

SPEAKER INSTALLATION

After the installation of the midwoofers make sure the tweeters are connected to the crossover network using the included cable harness. Please note that all wires from speaker to crossover network are already pre-assembled with cable push on connectors that can simply be installed. You should also carefully check for the right polarity of each connection for each left and right. You may want to use some strong, double-sided adhesive tape or hot glue to “semi-permanently” mount the crossovers. Make sure that you choose an appropriate recess in the door panel as a position for the crossover network itself, so that it does not interfere with any other part of the door panels when you reassemble the door

Removal of the door panel

In order to install the VPSBMW4 speakers in the original mounting positions it is mandatory to remove the door panels. If you are uncertain how to remove the panels, please either ask your local BMW dealer or an experienced car audio dealer for assistance.

In either case follow the instructions of the car manufacturer.

Here are some important hints:

1. The door panel is fastened with several hidden screws to the metal sheet of the door. Make sure that you have loosened all screws before you try to remove the door panel.
2. Additionally the door panel is fixed by numerous plastic clips, which may be damaged during the disassembly, especially if it is cold (below 50 degrees F). Always pull the door panel horizontally to loosen the clips – never apply any vertical force.

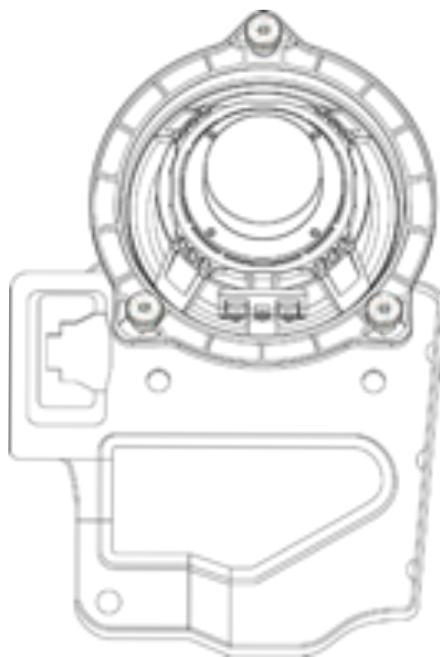

SPEAKER INSTALLATION - Continued

3. Double check to make sure that you have connected to the original speaker cable to the input of the Diamond Audio Crossover network. This requires cutting off the original OEM BMW connector with diagonal cutters. Never cut the cables directly behind the connector itself if you would like to reconnect them at a later date. The original speaker cables have to be equipped with the crimp terminals. These crimp terminals stick in one of the pre-assembled cables. If you don't have a dedicated crimping tool you can use the original cables as well. Installation of the Diamond Audio VSP4BMW component speakers

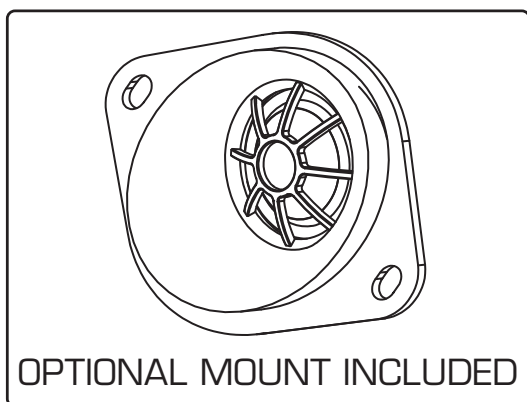

SYSTEM SETUP

Assuming that you are “reto” fitting your BMW with our Diamond Audio BMW specific speakers AND utilizing the stock “OEM” amplification there will be no need for any adjustments as the factory system is pre adjusted already.

BUT.....If you decide to use aftermarket amplification, make sure that they have an integrated, active crossover, and we recommend a high pass filter set at approx. 100 Hz.

Note that ANY broken plastic clips MUST be replaced before reinstalling the door panel in order to avoid undesired rattles and noise.

SPEAKER INSTALLATION - ADAPTERS NEEDED FOR EACH SERIES OF BMW (MINI too)

The following 3 pages of charts indicate which mounting adapters need to be used for your SPECIFIC BMW or MINI for the Diamond Audio 4 inch component speakers

BMW SERIES 4 THRU 7 MOUNTING HARDWARE CHART

Model	Version	Chassis	From year	To year	8"subwoofer	4 inch component
4 series	Gran Coupé	F36	2014	Current	underseat	Front: BMW-A Rear: BMW-A (Rear door) BMW-C (Rear shelf) Center: BMW-C
4 series	M4	F82	2014	Current	underseat	Front: BMW-A Rear: BMW-A Center: BMW-C
4 series	M4 Cabrio	F83	2014	Current	underseat	Front: BMW-A Rear: BMW-A (Rear door) BMW-C (Rear shelf) Center: BMW-C
5 series	Limo /Sedan	E60	2004	2010	underseat	Front: BMW-C Rear: BMW-C Center: BMW-C
5 series	Touring	E61	2004	2010	underseat	Front: BMW-C Rear: BMW-C Center: BMW-C
5 series	GT	F07	2009	2017	underseat	Front: BMW-C Rear: BMW-C Center: BMW-C
5 series	Sedan	F10	2010	2016	underseat	Front: BMW-B Rear: BMW-C Center: BMW-C
5 series	Touring	F11	2010	2016	underseat	Front: BMW-B Rear: BMW-C Center: BMW-C
5 series	Limo	F18	2010	2016	underseat	Front: BMW-B Rear: BMW-C Center: BMW-C
5 series	Limo / Sedan	G30	2017	Current	underseat	Front: BMW-B Rear: BMW-C Center: BMW-C
5 series	Touring	G31	2017	Current	underseat	Front: BMW-B Rear: BMW-C Center: BMW-C
6 series	Coupé	E63	2003	2010	underseat	Front: BMW-B Rear: BMW-B Center: BMW-C
6 series	Gran Coupé	E64	2003	2010	underseat	Front: BMW-B Rear: BMW-B Center: BMW-C
6 series	Gran Coupé	F06	2011	Current	underseat	Front: N/A Rear: BMW-B (Rear door) BMW-C (Rear shelf) Center: BMW-C
6 series	Cabrio	F12	2011	Current	underseat	Front: BMW-A Rear: BMW-B (Rear door) BMW-C (Rear shelf) Center: BMW-C
6 series	Coupé	F13	2011	Current	underseat	Front: BMW-A Rear: BMW-B (Rear door) BMW-C (Rear shelf) Center: BMW-C
6 series	Gran Coupé M	F14	2011	Current	underseat	Front: BMW-A Rear: BMW-B (Rear door) BMW-C (Rear shelf) Center: BMW-C
7 series	Sedan	F01	2008	2015	underseat	Front: BMW-C Rear: BMW-C Center: BMW-C
7 series	Limo	F02	2008	2015	underseat	Front: BMW-C Rear: BMW-C Center: BMW-C
7 series	Security	F03	2008	2015	underseat	Front: BMW-C Rear: BMW-C Center: BMW-C
7 series	Hybrid	F04	2008	2015	underseat	Front: BMW-C Rear: BMW-C Center: BMW-C
7 series	Sedan	G11	2016	Current	underseat	Front: BMW-C Rear: BMW-C Center: BMW-C
7 series	Limo	G12	2016	Current	underseat	Front: BMW-C Rear: BMW-C Center: BMW-C

BMW SERIES 1 THRU 4

MOUNTING HARDWARE CHART

Model	Version	Chassis	From year	To year	8"subwoofer	4 inch component
1 series	3-Door	E81	2007	2012	underseat	Front: BMW-B Rear: BMW-C Center: BMW-C
1 series	Coupé	E82	2007	2013	underseat	Front: BMW-B Rear: BMW-C Center: BMW-C
1 series	5-Door	E87	2004	2011	underseat	Front: BMW-B Rear: BMW-C Center: BMW-C
1 series	Cabrio	E88	2007	2013	underseat	Front: BMW-B Rear: BMW-B Center: BMW-C
1 series	5-Door	F20	2011	Current	underseat	Front: BMW-A Rear: BMW-A Center: BMW-C
1 series	3-Door	F21	2012	Current	underseat	Front: BMW-A Rear: BMW-A Center: BMW-C
1 series	Sedan	F52	2015	Current	underseat	Front: BMW-B Rear: BMW-C Center: BMW-C
2 series	Coupé	F22	2014	Current	underseat	Front: BMW-A Rear: BMW-C Center: BMW-C
2 series	Cabrio	F23	2014	Current	underseat	Front: BMW-A Rear: BMW-A Center: BMW-C
2 series	Active Tourer	F45	2015	Current	underseat	Front: BMW-A Rear: BMW-A Center: BMW-C
2 series	Gran Tourer	F46	2015	Current	underseat	Front: BMW-A Rear: BMW-A Center: BMW-C
2 series	M2	F87	2015	Current	underseat	Front: BMW-A Rear: BMW-C Center: BMW-C
3 series	Limo/ Sedan	E90	2005	2011	underseat	Front: BMW-B Rear: BMW-C Center: BMW-C
3 series	Touring	E91	2005	2012	underseat	Front: BMW-B Rear: BMW-B Center: BMW-C
3 series	Coupé	E92	2006	2013	underseat	Front: BMW-B Rear: BMW-C Center: BMW-C
3 series	Cabrio	E93	2007	2013	underseat	Front: BMW-B Rear: BMW-B Center: BMW-C
3 series	Sedan	F30	2012	Current	underseat	Front: BMW-A Rear: BMW-A (Rear door) BMW-C (Rear shelf) Center: BMW-C
3 series	Touring	F31	2012	Current	underseat	Front: BMW-A Rear: BMW-A Center: BMW-C
3 series	GT	F34	2013	Current	underseat	Front: BMW-A Rear: BMW-A (Rear door) BMW-C (Rear shelf) Center: BMW-C
3 series	Limo	F35	2014	Current	underseat	Front: BMW-A Rear: BMW-A (Rear door) BMW-C (Rear shelf) Center: BMW-C
3 series	M3	F80	2014	Current	underseat	Front: BMW-A Rear: BMW-A (Rear door) BMW-C (Rear shelf) Center: BMW-C
4 series	Coupé	F32	2013	Current	underseat	Front: BMW-A Rear: BMW-A (Rear door) BMW-C (Rear shelf) Center: BMW-C
4 series	Cabrio	F33	2013	Current	underseat	Front: BMW-A Rear: BMW-A Center: BMW-C

BMW ADAPTER CHARTS (AND MINI)

MINI

MOUNTING HARDWARE CHART

Mini	Clubman	F54	2015	Current	underseat	Front: BMW-A Rear: BMW-A Center: BMW-C
Mini	5-door Hatch	F55	2014	Current	underseat	Front: BMW-A Rear: BMW-A Center: BMW-C
Mini	3-door Hatch	F56	2014	Current	underseat	Front: BMW-A Rear: BMW-A Center: BMW-C
Mini	Clubman	R55	2006	2014	underseat	Front: BMW-C Rear: BMW-C Center: N/A
Mini	3-door Hatch	R56	2006	2013	underseat	Front: BMW-C Rear: BMW-C Center: N/A
Mini	Cabrio	R57	2008	2014	underseat	Front: BMW-C Rear: BMW-C Center: N/A
Mini	Coupé	R58	2011	2015	underseat	Front: BMW-C Rear: BMW-C Center: N/A
Mini	Roadster	R59	2011	2015	underseat	Front: BMW-C Rear: BMW-C Center: N/A
Mini	Country- man	R60	2010	2016	underseat	Front: BMW-C Rear: BMW-C Center: N/A
Mini	Paceman	R61	2012	2016	underseat	Front: BMW-C Rear: BMW-C Center: N/A
Mini	Country- man	F60	2017	Current	underseat	Front: BMW-A Rear: BMW-A Center: BMW-C
Mini	Cabrio	F57	2015	Current	underseat	Front: BMW-A Rear: BMW-A Center: BMW-C
X1	SUV	E84	2010	2015	underseat	Front: BMW-B Rear: BMW-C Center: BMW-C
X1	SUV	F48	2016	Current	underseat	Front: BMW-A Rear: BMW-A (Rear door) BMW-C (Rear shelf) Center: N/A
X1	SUV	F49	2016	Current	underseat	Front: BMW-A Rear: BMW-A (Rear door) BMW-C (Rear shelf) Center: N/A
X3	SUV	E83	2003	2010	underseat	Front: BMW-C Rear: BMW-C Center: BMW-C
X3	SUV	F25	2011	2017	underseat	Front: BMW-A Rear: BMW-A (Rear door) BMW-C (Rear shelf) Center: BMW-C
X4	SUV	F26	2014	Current	underseat	Front: BMW-A Rear: BMW-A Center: BMW-C
X5	SUV	E70	2007	2013	underseat	Front: BMW-C Rear: BMW-C Center: BMW-C
X5	SUV	F15	2014	Current	underseat	Front: N/A Rear: BMW-C(D-pillar) Center: BMW-C
X5	X5 M	F85	2014	Current	underseat	Front: N/A Rear: BMW-C(D-pillar) Center: BMW-C
X6	SUV	E71	2008	2014	underseat	Front: BMW-C Rear: BMW-C Center: BMW-C
X6	Hybrid	E72	2008	2014	underseat	Front: BMW-C Rear: BMW-C Center: BMW-C
X6	SUV	F16	2014	Current	underseat	Front: N/A Rear: BMW-C(D-pillar) Center: BMW-C
X6	X6 M	F86	2014	Current	underseat	Front: N/A Rear: BMW-C(D-pillar) Center: BMW-C
Z4	Roadster	E89	2009	2016	underseat	Front: BMW-C Rear: BMW-C Center: N/A"

BMW SUV

MOUNTING HARDWARE CHART

BMW-A

(Variant A)

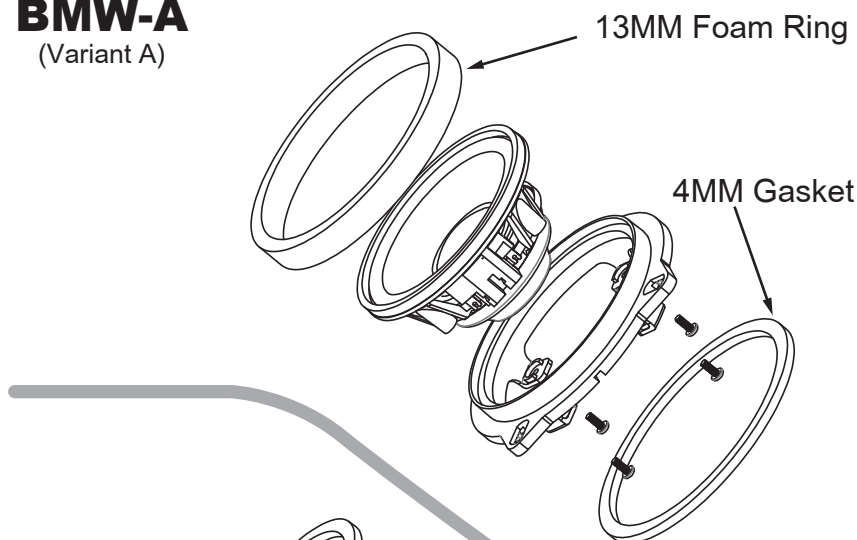

BMW-B

(Variant B)

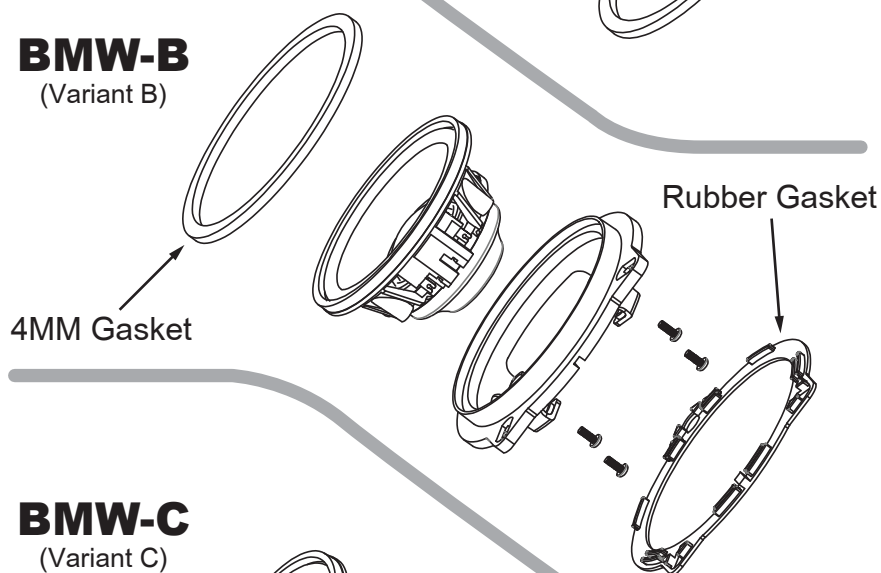

BMW-C

(Variant C)

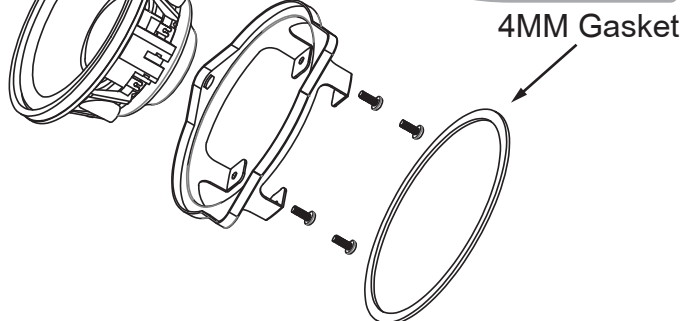

LIMITED SPEAKER WARRANTY STATEMENT

Diamond Audio Technologies, (CV & DA HOLDINGS INC.) warrants this product to be free from defects in material and workmanship for a period of one (1) year from the original date of purchase provided it was purchased from an authorized DAT retailer within the United States. Product warranty period starts at date of purchase or one year past manufacture date whichever is first. However, upon purchase, completion of the online registration and installation by an authorized DAT dealer your warranty period will be extended to two (2) years. This warranty extension offer will only be recognized upon completion of the online registration of your product within 30 days of the date of purchase.

THIS WARRANTY IS NOT TRANSFERABLE AND APPLIES ONLY TO THE ORIGINAL PURCHASER OF THIS PRODUCT IN ITS ORIGINAL INSTALLATION. Original purchaser must reside in the United States and be able to provide proof of purchase and installation with the sales receipt and completion of online registration from the authorized DAT retailer that sold and installed the product.

Should a manufacturing defect occur during above said warranty period, DAT will replace or repair the defective product with a product of the same or equivalent value and performance.

Damage or failure caused by any of the following is not covered under this warranty policy: negligence, improper use, abuse, product modification, unauthorized repair attempts, accident, acts of God, misrepresentations by DAT retailers, and improper/inadequate packaging during return shipping.

Warranty is void if serial numbers have been removed, altered or defaced.

HOW TO OBTAIN WARRANTY SERVICE

In the event a DAT product should require service, you should visit the authorized DAT retailer you purchased the product from and they can expedite your claim. All claims must fall into the guidelines listed above and be accompanied by a copy of the original sales and installation receipt from that authorized DAT retailer.

Product returned for warranty service must be freight-prepaid, properly packaged and clearly marked with the Return Authorization (RA) number issued by DAT. Any product returned to DAT that is improperly packaged, does not have a RA number clearly marked on the package, or never received a RA number may be refused upon delivery. DAT does not assume responsibility for lost or misdirected product.

Repair or replacement under this warranty is the exclusive remedy of the consumer. DAT shall not be liable for any incidental or consequential damages for breach of any expressed or implied warranty on this product. Some states do not allow the exclusion or limitation of incidental or consequential damages, or allow limitations on how long an implied warranty lasts, so the above limitations or exclusions may not apply to you. This warranty gives you specific legal rights and you may also have other rights that may vary from state to state.

Customers outside the United States should contact their local sales office to obtain information on pricing, exchange unit availability, instructions, service and warranty/non-warranty replacement or repair.

Diamond Audio Technologies

3761 S. HILL ST
LOS ANGELES, CA 90007

Tel: 213-261-4161

Fax: 213-947-4767

Web: diamondaudio.com

Service/Tech Support:

213-261-4161

Tech Support Email

techsupport@diamondaudio.com



DIAMOND
AUDIO

(a division of CV & DA Holdings, Inc.)
3761 S. Hill St.
Los Angeles, CA. 90007

www.DiamondAudio.com