

PRODUCT FEATURES:

- Retains factory features in select GM LAN 29 Bit vehicles while functioning with an aftermarket radio.
- Pre-programmed to retain factory Steering Wheel Controls.
- iPhone Voice Recognition (VR) feature from SWC on select radios.
- Supports Pick Up/End Call, Pick up and Toggle between 1st and 2nd incoming call, AVRCP Track, Seek.
- Supports Bose, non-Bose and Y-91 audio systems.
- Retains chime functions.
- Provides Factory Rear Seat Entertainment Activation. Requires Cable #CRUX2333A (sold separately).
- Retains factory backup camera.*
- Retains factory backup sensors / park assist system.
- EIA color coded wiring for easy installation.

NOTE:

Does not retain the factory backup camera on models that show the camera image on the rearview mirror.

PARTS INCLUDED:



SWRGM-49 MODULE



SWRGM-49 HARNESS



SWC CABLES



ANTENNA ADAPTER



Backup Camera Harness

INSTALLATION DIAGRAM:

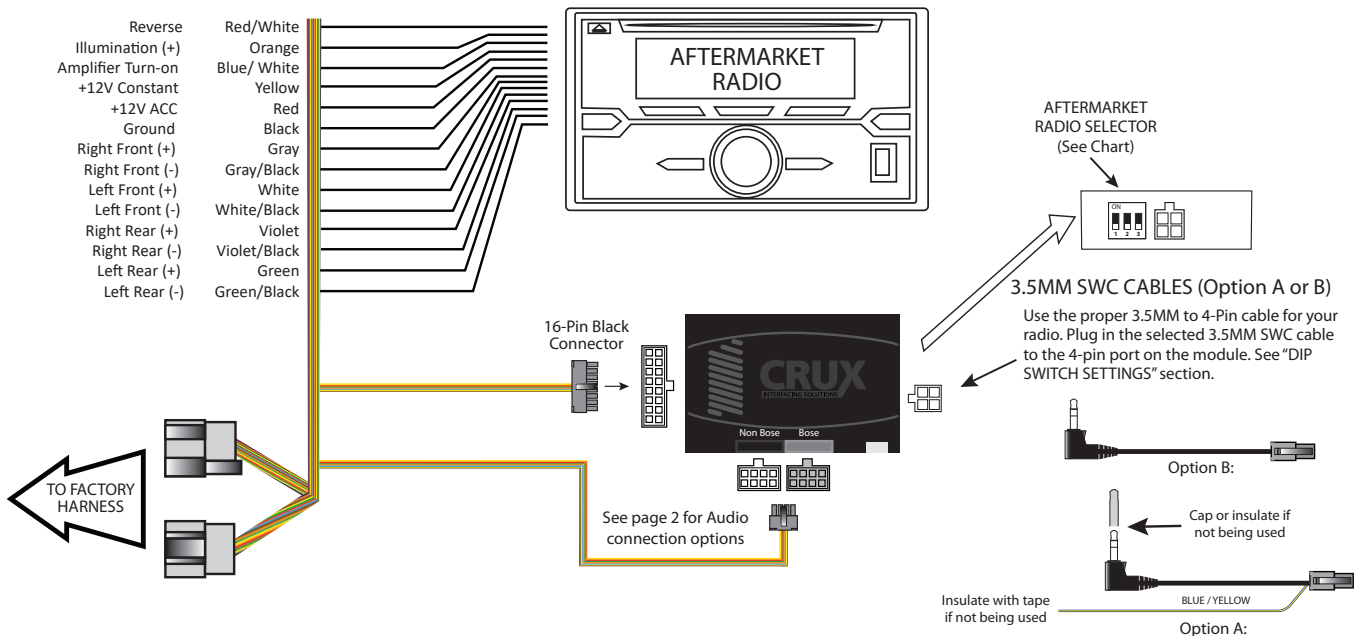

DIP SWITCH SETTINGS:

AFTERMARKET RADIO DIP SWITCH SETTINGS:

RADIO BRAND:	DIP#:	1	2	3
Atoto, Dual, Fahrenheit, Jensen		OFF	ON	ON
Pioneer, Power Acoustik, Soundstream		OFF	ON	ON
Blaupunkt, Most off-brand Radio		OFF	ON	ON
Alpine		OFF	OFF	OFF
Clarion		ON	ON	OFF
Kenwood		ON	ON	ON
JVC		ON	OFF	ON
Boss, Old Sony		ON	OFF	OFF
New Sony		OFF	ON	OFF

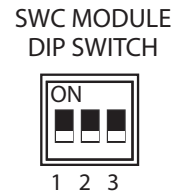

NOTE: For Atoto, Blaupunkt, Dual, Fahrenheit, Power Acoustik, Soundstream, and most off-brand radios, check the aftermarket radio's manual to see if the SWC buttons need to be programmed.

4-PIN SWC CABLE

Use the proper 3.5MM to 4-Pin SWC cable for the aftermarket radio you are using.

OPTION A is used for ALPINE, CLARION, JVC, and KENWOOD units (Blue/Yellow wire is attached)
OPTION B is used for ATOTO, BLAUPUNKT, BOSS, DUAL, FARENHEIT, JENSEN, POWER ACOUSTIK, PIONEER, SONY, SOUNDSTREAM and Most Off-Brand Radios.

NOTE: Cap or insulate the 3.5mm plug or Blue/Yellow wire if not being used.

For aftermarket radios that have wires for SWC connections, cut off the 3.5mm plug on the Crux SWC Cable (option B) and connect the SWC wires as follows:

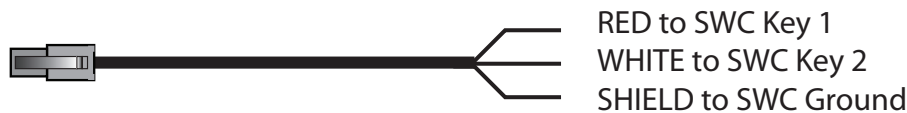

Note that there are some radios that only have SWC1 and SWC2, in this case "shield" does not need to be connected.

SELECTING THE AUDIO SYSTEM:

If the vehicle is equipped with an amplified audio system, the SWRGM-49 has a built-in audio level adaptor that outputs the proper audio level from the aftermarket radio to the factory amplifier. To use this feature, plug in the male 8-pin connector on the SWRGM-49 harness to the GRAY female 8-pin connector on the SWRGM-49 module. The module is also labeled "Bose" and "Non Bose" to avoid confusion. (see picture below)

If the vehicle is NOT equipped with a factory amplified system, plug in the male 8-pin connector to the BLACK female 8-pin on the SWRGM-49 module.

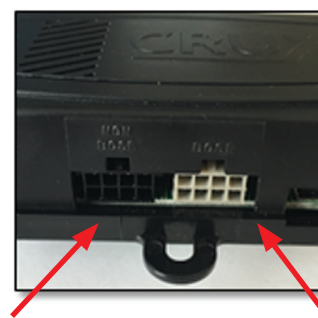

NON BOSE (Non-Amplified) Connection BOSE (Amplified) Connection



CHIME VOLUME ADJUSTMENT:

The SWRGM-49 has a potentiometer to adjust the chime volume. It is set at half way by default. To adjust the volume, simply use a suitable screw driver and turn the potentiometer clockwise to increase the volume and counter-clockwise to decrease the volume.

Chime
 Volume
 Adjustment



BACKUP CAMERA CONNECTION:

You can retain the factory back-up camera by using the CRUX 2543 harness included in the kit.

1. Connect the 16-pin back-up camera harness to the vehicle's 16-pin factory backup camera connector.
2. Connect the Yellow video RCA to the new aftermarket radio camera input.
3. Test the video feed before installing the radio back into the dashboard.

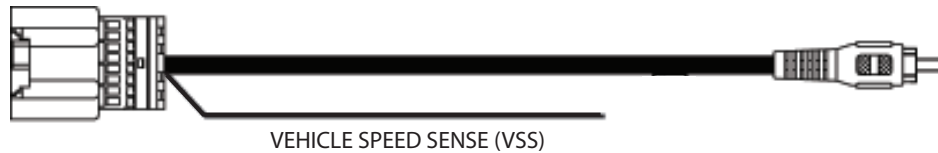

NOTE:

Does not retain the factory backup camera on models that show the camera image on the rearview mirror.

VEHICLE APPLICATIONS:

BUICK		GMC	
2008-2017	Enclave	2007-2016	Acadia
2006-2011	Lucerne	2017	Acadia Classic
CADILLAC		2008-2017	Savana**
2007-2014	Escalade	2007-2013	Sierra 1500-3500 Pickup*
2007-2009	SRX	2007-2014	Yukon*
CHEVROLET		HUMMER	
2007-2013	Avalanche*	2008-2009	H2
2007-2008	Equinox	PONTIAC	
2008-2016	Express Van**	2007-2009	Torrent
2006-2013	Impala / Impala SS	SATURN	
2014-2016	Impala Classic	2007-2009	Outlook
2006-2007	Monte Carlo	2008-2009	Vue
2007-2013	Silverado 1500-3500 Pickup*	SUZUKI	
2007-2014	Suburban*	2007-2008	XL7
2007-2014	Tahoe*		
2009-2017	Traverse		

1. *NOT compatible with 2012-Up SUVs/Trucks that are equipped with factory-installed Navigation radios.
2. **NOT compatible with Express and Savana vans that are powered by a diesel engine.

