

## THANK YOU FOR YOUR PURCHASE . . .

Your product has been designed to provide you the performance and ease of operation you expect from JBL. Take time to read this manual before operating or installing your BassPro Go. This manual describes general installation guidelines and operation instructions. Please note that proper installation of mobile audio components requires qualified experience with mechanical and electrical procedures. If you do not have the knowledge and tools to perform this installation, we strongly recommend consulting an authorized JBL dealer about your installation options.

## I. PRODUCT DESCRIPTION

JBL BassPro Go is a powered subwoofer designed to easily mount and charge in any vehicle. It acts as a subwoofer or a full-range speaker in the vehicle; and, with its quick-disconnect feature, becomes a portable Bluetooth speaker. It features easy-to-use controls and a convenient safety cover to help protect the speaker when used out of the vehicle, and to provide an IPx5 marine rating.

## II. WHAT'S IN THE BOX

- |                                     |                              |                   |
|-------------------------------------|------------------------------|-------------------|
| 1x portable speaker                 | 1x remote bass controller    | Mounting hardware |
| 1x vehicle mounting dock            | 2x high-level input adapters | 2x JBL stickers   |
| 1x wiring harness with in-line fuse | 1x spare fuse                | 1x owner's manual |

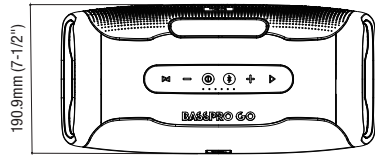
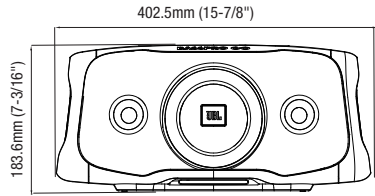
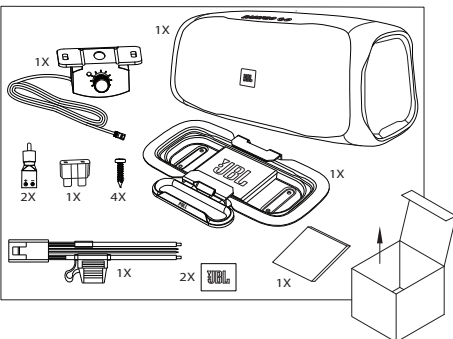

## III. INSTALLATION AND WIRING

**IMPORTANT: Disconnect the vehicle's negative (-) battery terminal before beginning the installation.**

- Wear protective eyewear when using tools.
- Choose a safe mounting location. Check clearances on both sides of the location. Be sure that screws will not puncture brake or fuel lines or wiring harnesses, and that wire routing will not interfere with vehicle operation. Use caution when drilling or cutting.
- When making electrical connections, make sure they are secure and properly insulated.
- Using the dock as a template, mark the locations of the holes on the mounting surface.
- Drill pilot holes in the mounting surface.
- Attach the dock to the mounting surface with the included sheet metal screws and washers.

### A. Mounting the dock in the vehicle

Use the included sheet metal screws to secure the dock to the mounting surface in the vehicle. Ensure that the included wire is long enough to reach the desired mounting location before securing the dock.

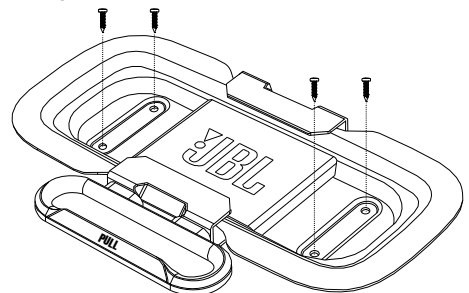

## B. Mounting the speaker in the dock

1. Pull the handle out.

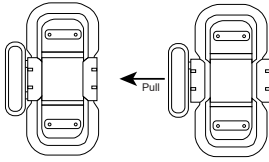

2. Rest one corner of the speaker on the dock at a slight angle to get the speaker seated.
3. Rotate the speaker until it is completely in place in the dock.

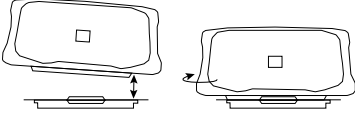

4. Release the handle to finish securing in place.

**NOTE:** It will be easiest to connect the wire harness before mounting the speaker in the dock.

## C. Power and Ground Connections in the vehicle

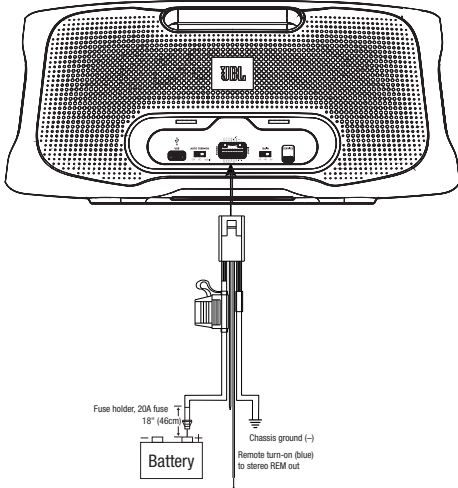

- Power:** Connect the red **+12V** power wire in the wire harness to the positive terminal of the vehicle battery. Install a 20A fuse and fuse holder within 18" (457mm) of the battery.
- Ground:** Connect the black **GND** wire in the wire harness to bare metal of the vehicle's chassis, such as at a seat belt bolt.
- Remote-In:** Connect the blue remote turn-on wire in the wire harness to the "Remote Out" lead of the source unit, if using low-level signal inputs.

**NOTE:** 12V ACC turn-on is the preferred method. If you are using high-level signal inputs (vehicle speaker wires), you can choose to have the DC offset feature or the audio-sensing feature turn the amplifier on. You will not have to connect the remote turn-on wire and can terminate the connection.

## D. Power/Protect indicators when connected to the vehicle



The power button on the control panel indicates the speaker's modes of operation.

Illumination color	Mode of operation
White	Subwoofer mode (in vehicle only)
Green	Full-range mode
Red	Protect mode (over/under voltage/short circuit/amplifier circuit failure/excessive heat)
Yellow	Settings mode

## E. Signal input in the vehicle

**Line-level inputs:** If your source unit offers preamp outputs, connect them to the RCA inputs in the wire harness. Use front or rear preamp outputs for full-range operation, or subwoofer preamp outputs (if available) for subwoofer mode.

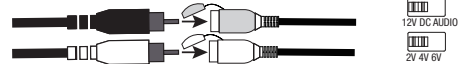

**Note:** When using low-level signals and remote turn-on lead, set the "Auto Turn-on" switch to "12V," and set the speaker's input level to "LO" in the settings menu (see "setting the input level"). Set the "Auto-on" switch to 2V, 4V, or 6V, whichever most closely matches the voltage of your source unit's preamp outputs.

**High-level inputs:** If your source unit does not have line-level outputs, use the supplied high-level input adapters to connect to the speaker output wires of your source unit to the RCA inputs in the wire harness.

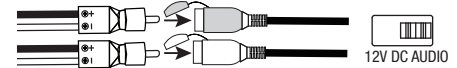
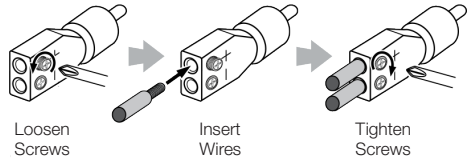

**NOTE:** When using high-level signals, set the "Auto Turn-on" switch to "DC" (to turn on when it receives battery power) or "AUDIO" (to turn on when it senses audio signal). Set the input level to "HI1" in the settings menu (see "setting the input level"). If no sound plays, change the input level to "HI2".

## F. Connecting the remote bass control in the vehicle

Plug the remote bass controller into the appropriate input in the wire harness. Mount the remote in a convenient location, such as under the dash, using sheet metal screws.

Turn the dial clockwise to increase the bass output, and counterclockwise to decrease the bass output.

**NOTE:** Remote bass control will only operate in subwoofer mode.

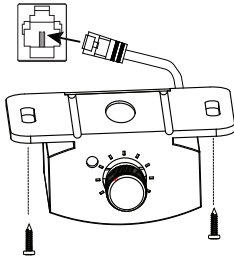

## IV. SETTING THE SOUND IN THE VEHICLE

In Settings Mode, you can adjust the input level, gain, low-pass crossover, phase control, and bass boost.

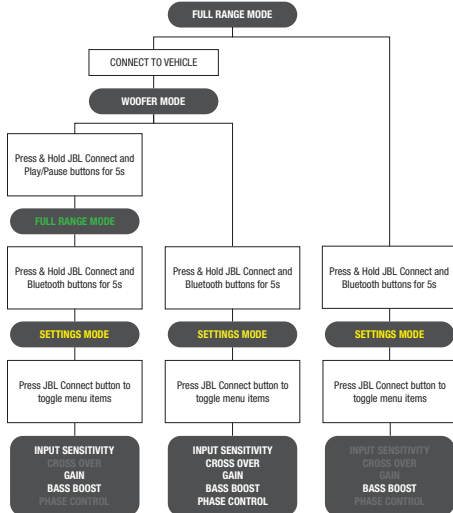

**NOTE:** To enter Full-Range Mode from Subwoofer Mode, press and hold the JBL Connect and Play/Pause buttons for 5 seconds. To switch back to Subwoofer Mode, repeat the same process.

### A. Entering Settings Mode

Press and hold the JBL Connect button and the Bluetooth button for 5 seconds to enter Settings Mode. The power button will illuminate in yellow and an alert will sound. Press the JBL Connect button to toggle between settings. Press the "+" and "-" buttons to change the value of each setting.

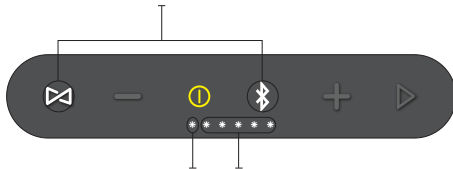

The color of the first LED indicates which setting you are adjusting. The five white LEDs display the value of the adjustment.

Setting	First LED color
Input level (docked in vehicle only)	Blue
Crossover (docked in vehicle in woofer mode only)	Red
Gain (docked in vehicle only)	Green
Bass boost	Orange
Phase (docked in vehicle in woofer mode only)	Teal

EN

### B. Setting the input level

When the BassPro Go is docked in your vehicle, you will need to set the input level to accept the type of signal it receives from your source unit. Select level options by pressing the "+" and "-" buttons.

Signal from source unit	LED configuration
LO (low-level preamp outputs)	
HI1 (high-level speaker outputs)	
HI2 (high-level speaker outputs if no playback from HI1)	

### C. Setting the low-pass crossover in subwoofer mode

The crossover allows only frequencies below a certain point to reach the speaker in woofer mode. The crossover point you choose depends on your musical preferences.

Crossover point	LED configuration
80Hz	
100Hz	
120Hz	

### D. Setting the gain

When the BassPro Go is docked in your vehicle, you will need to match the gain (input sensitivity) to output of the signal it receives from your source unit. To set the gain:

1. Start with gain control switch set to 2V.
2. Choose music with substantial bass content and turn the volume control on your receiver to 75% of its total output.
3. Increase the gain one step at a time by pressing the "+" button, listening carefully to the bass output, as the LED read out displays each step. To increase the interval of the gain you are adjusting, move the gain control switch to 2V, 4V, or 6V as necessary. If you hear distortion, lower the gain one step at a time by pressing the "-" button until the distortion disappears.

Input signal type	Gain control switch setting	Gain level	LED configuration
Line-level	2V	0.4V - 2V	
Line-level	4V	0.8V - 4V	
Line-level	6V	1.2V - 6V	
High-level	2V	1V - 5V	
High-level	4V	2V - 10V	
High-level	6V	3V - 15V	

## E. Setting the bass boost

You can apply a boost to the output at 45Hz in subwoofer mode and in full-range mode.

Boost level	LED configuration
0dB	
3dB	
6dB	

## F. Setting the woofer phase

You can set the woofer phase to 0° or 180°, whichever provides the cleanest bass output.

Phase	LED configuration
0°	
180°	

## G. Using the speaker in Full-Range Mode in vehicle

To enter Full-Range Mode, press and hold the Connect button and Play/Pause button simultaneously for 5 seconds. Repeat the process to return to Subwoofer Mode.

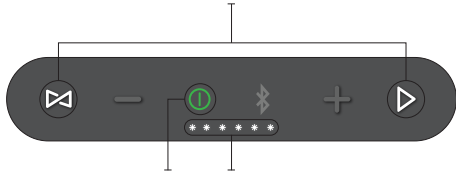

The power button will turn green, the five white LEDs will flash, and an alert will sound to indicate Full-Range Mode.

**NOTE:** You can adjust input level, gain, phase, and bass boost in Full-Range mode, as described above. (Crossover cannot be adjusted in Full-Range Mode.)

## V. RELEASING THE SPEAKER FROM THE DOCK FOR PORTABLE USE

### A. Follow these steps to remove the speaker from the dock

1. Pull the handle at the base of the dock forward.
2. Disconnect the wire harness by gently pressing down on the tab at the top of the plug, then pulling gently away.

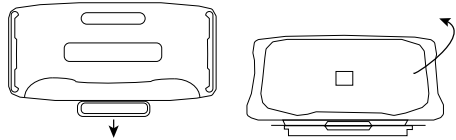

3. Lift away from the dock.

### B. Replacing the back-panel cover

To ensure IPX5 water-resistant performance, replace the cover on the back panel by pressing it into place.

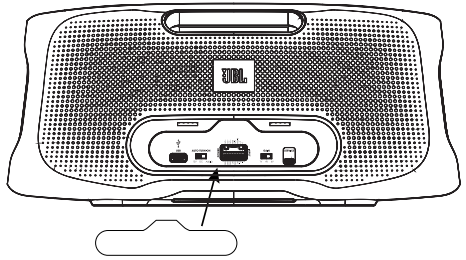

## C. Connecting an audio device with Bluetooth

To enter pairing mode, press the Bluetooth button on the top panel. The button will flash to indicate that it is ready for pairing.

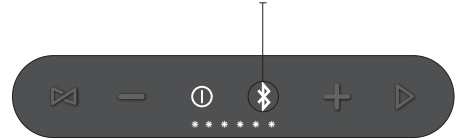

Find JBL BassPro Go on your audio device and select it. The Bluetooth button will remain illuminated when pairing is complete.

**NOTE:** Once you have paired a device, the BassPro Go will remember it and pair with it automatically.

You can enjoy Social Mode and pair up to two more devices by pressing the Bluetooth button, then finding the BassPro Go in the menus of each Bluetooth device and tapping to pair.

The BassPro Go will enter sleep mode after 10 minutes of inactivity, and power off after 20 minutes of inactivity. Press the power button to turn the speaker back on.

Bluetooth button color/behavior	Mode of operation
White, flashing	Bluetooth is in pairing mode
White, solid	Bluetooth is connected
Off	Bluetooth is disconnected

## D. Adjusting playback volume and selecting play/pause when in portable use

To raise the volume when using the BassPro Go as a portable speaker, press the Volume Up (+) button. To lower it, press the Volume Down (-) button. To play or pause, press the Play/Pause button.

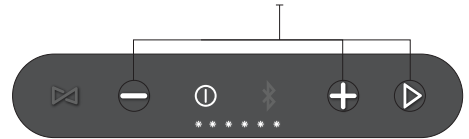

**NOTE:** You can also adjust the playback volume and play/pause using the controls on your Bluetooth music device.

**NOTE:** You can adjust the bass boost using the same steps described in the Settings Mode section above. Increased bass boost will shorten battery life.

## E. Charging a music device with the BassPro Go undocked

The BassPro Go lets you charge your music device with its built-in USB port. To charge your device:

1. Remove the cover from the back panel.
2. Plug the USB power cable of your device into the USB port on the back panel of the BassPro Go.

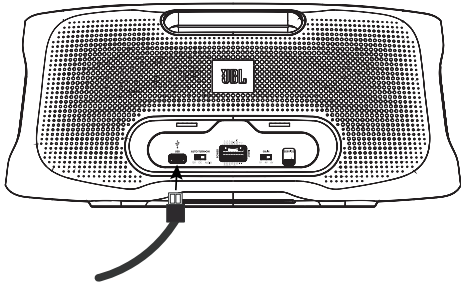

## F. Connecting to another JBL speaker using JBL Connect

You can link a second JBL BassPro Go, for simultaneous playback of two speakers. To link your devices:

1. Press the JBL Connect button. The power button will flash white.



2. The devices will automatically connect. When they are connected, the power button will turn blue.

**NOTE:** If the devices do not connect, the power button will return to solid white. Try the process again. BassPro Go is not compatible with JBL Connect+ or JBL Party Mode enabled products.

Power button color/behavior	Mode of operation
White, solid	Power is on
White, flashing	Speaker is in JBL Connect pairing mode
Blue, solid	Speaker is connected to a second speaker with JBL Connect

## G. Monitoring battery level in portable mode

The LED readout will show you the level of the battery when in portable mode.

Battery level	LED configuration
100%-81%	● ● ● ● ● ●
80%-61%	● ● ● ● ● ●
60%-41%	● ● ● ● ● ●
40%-21%	● ● ● ● ● ●
20%-11%	● ● ● ● ● ●
≤10%	● ● ● ● ● ●

## VI. SPECIFICATIONS

- RMS Power Output in-vehicle, subwoofer mode: 100 watts (200 watts peak)
- RMS Power Output in-vehicle, full-range mode: 2x30 watts (tweeter) & 1x80 watts (woofer)
- RMS Power Output out-of-vehicle, full-range mode: 2x15 watts (tweeter) & 1x40 watts (woofer)
- Amplifier Class: Class D
- Battery Voltage Range (Volts) : 9V to 16V
- Quiescent current: <1.2A
- Selectable Turn-on Modes: 12V, Audio Signal Sense, DC Offset
- LED Indicator: multicolor
- Total Frequency Response: 40Hz to 20kHz @ -3dB
- Signal-to-Noise Ratio: >70dB (1W output at 4 ohms)
- THD+N @ 4-ohm: <1%
- Input Sensitivity, selectable: High-level or low-level
- Input Sensitivity - Low Level: 400mV to 6V
- Input Sensitivity - High Level: 1V to 15V
- Low-pass crossover: Selectable 80, 100, 120Hz @ 12dB slope
- Bass Boost: Selectable 0dB / 3dB / 6dB @ 45Hz
- Phase Control: Yes, selectable
- Gain: Selectable 0-15
- Fuse Rating: 15A
- Speaker Level Inputs: Yes (RCA adapter)
- Remote Bass Control: Included
- Bluetooth Version: 4.2
- Bluetooth Profile: A2DP 1.3, AVRCP 1.6
- Bluetooth Transmitter Frequency Range: 2.402GHz – 2.480GHz
- Bluetooth Maximum Transmitter Power: 0 – 9dBm
- Bluetooth Transmitter Modulation: GFSK, 8DPSK, π/4DQPSK
- Battery type: Ni-MH (32.4Wh)
- Battery charge time: <4 hours
- Music playing time: Up to 8 Hours (Varies by volume level and music content)
- USB Charging (Type A connector) : 5V / 2.1A
- Micro USB: For Service Only
- Length: 402.5mm (15-7/8")
- Width: 208.4mm (8-3/16")
- Height: 198.7mm (7-13/16")
- Weight: 5.28kg (11.64lbs)
- Protection: DC, OVP, UVP, OCP, OTP

## VII. TROUBLESHOOTING

### No audio and POWER INDICATOR is off

- No voltage at BATT+ and/or REM terminals, or bad or no ground connection. Check voltages at amplifier terminals with VOM.

### No audio and PROTECT INDICATOR is on

- Check to see if the input voltage is less than 9V or greater than 16V on BATT+ connection and vehicle charging system.

### In-line fuse keeps breaking

- The wiring is connected incorrectly or there is a short circuit. Review installation precautions and procedures. Check wiring connections.

### Distorted audio

- Gain is not set properly. Check and adjust settings. Speaker or source unit may be defective.

### Unwanted noise in the audio signal

- Radiated vehicle noise in the line-level input cables. Make sure power wire and signal wires are not near each other (run them down opposite sides of the vehicle).

### Music lacks dynamics or "punch"

- Use 0°/180° phase adjustment.

### Loudness or audio performance varies with Bluetooth

- Loudness and volume will vary between phones. If you feel that the product is not loud enough, check your phone settings to see if any adjustments can be made to improve audio performance, or try using a different audio source or Bluetooth streaming device to determine if performance improves.

### Audio play/pause, track forward or track back are slow to respond in Bluetooth mode

- This will vary by phone or Bluetooth streaming device. Try using a different Bluetooth streaming device to see if this improves. If the problem persists, cycle the power off and let the speaker rest for a few minutes before turning power on.

### Audio track is cutoff in first few seconds when using track forward or track back

- This will vary by phone and the capability of the phone to communicate with Bluetooth control from an external device. Try using a different Bluetooth streaming device to see if this improves.

Торговая марка: JBL  
 Назначение товара: Активная акустическая система  
 Изготовитель: Харман Интернешнл Индастриз Инкорпорейтед, США, 06901 Коннектикут, г.Стэмфорд, Атлантик Стрит 400, офис 1500  
 Страна происхождения: Сделано в Китае  
 Импортёр: ООО «ХАРМАН РУС СиАйЭс», Россия, 127018, г.Москва, ул. Двинцев, д.12, к. 1  
 Гарантийный период: 1 год  
 Срок службы: 3 года  
 Информация о сервисных центрах: www.harman.com/ru  
 Техническая поддержка: 8 (800) 700 0467  
 Организация, уполномоченная на принятие претензий потребителей: ООО «ХАРМАН РУС СиАйЭс»  
 Товар сертифицирован  
 Дата производства:

Дата изготовления устройства определяется по двум буквенным обозначениям из второй группы символов серийного номера изделия, следующих после разделительного знака «-». Кодировка соответствует порядку букв латинского алфавита, начиная с января 2010 года: 000000-МУ0000000, где «М» - месяц производства (А - январь, В - февраль, С - март и т.д.) и «У» - год производства (А - 2010, В - 2011, С - 2012 и т.д.).

Используйте устройство только по прямому назначению в соответствии с предоставленной инструкцией. Не пытайтесь самостоятельно вскрыть корпус товара и осуществлять ремонт. В случае обнаружения недостатков или дефектов, обращайтесь за гарантийным обслуживанием в соответствии с информацией из гарантийного талона. Особые условия хранения, реализации и (или) транспортировки не предусмотрены. Избегайте воздействия экстремальных температур, длительного воздействия влаги, сильных магнитных полей. Устройство предназначено для работы в жилых зонах. Срок годности не ограничен при соблюдении условий хранения. Пожалуйста, не утилизируйте устройства с литий-ионными аккумуляторами вместе с бытовыми отходами.

Max Operation Temperature: 45°C



The Bluetooth® word mark and logos are registered trademarks owned by Bluetooth SIG, Inc. and any use of such marks by HARMAN International Industries, Incorporated is under license. Other trademarks and trade names are those of their respective owners.



Este produto está homologado pela Anatel, de acordo com os procedimentos regulamentados para avaliação da conformidade de produtos para telecomunicações e atende aos requisitos técnicos aplicados. Para maiores informações, consulte o site da Anatel – www. anatel.gov.br Este equipamento não tem direito à proteção contra interferência prejudicial e não pode causar interferência em sistemas devidamente autorizados.

## 哈曼产品保修卡



机身编号:

产品型号: \_\_\_\_\_

销售 (安装调试) 日期: 20\_\_年\_\_月\_\_日 发票号码: \_\_\_\_\_ (销售者印章)

用户姓名: \_\_\_\_\_ 联系电话: \_\_\_\_\_

地址 (邮编): \_\_\_\_\_

**重要提示:** 根据国家“三包”规定, 您必须完整填写本凭证并与购买发票原件同时出示方可享受相关售后服务。为了保护您的权益, 请您购买产品时索取合法有效的发票并请将经销商在本凭证盖章包括名称、地址、电话等信息的印章。本凭证内容与商品实物标识不符或者涂改的将不提供售后服务, 请务必妥善保管。请您核对产品机身编号, 编号缺失、涂改或经查询非本公司授权经销商渠道销售产品均不提供售后服务。更多信息请您阅读下面的产品保修条例。

**哈曼 (中国) 投资有限公司**  
 公司地址: 上海市黄浦区南京西路 288 号 3004 室  
 中国大陆地区客服热线: 400 630 6678



扫描二维码获取全国联保

### 产品保修期:

JBL INFINITY 汽车音响产品提供一年的保修期, 自消费者在本公司授权经销商、授权安装点购买之日 (即, 购买发票所述的日期) 起算。

### 保修范围:

产品在上述保修期内出现故障, 且经本公司授权经销商、授权安装点或授权维修站工程师检测确认属于正常使用情况下, 由于制造过程或零件损坏/失灵所导致的故障, 本公司将为您提供免费修理及零件更换。

### 下列情形不属于保修范围

包括但不限于未按产品使用说明书要求使用 (包括但不限于非汽车 12V 直流水源环境使用)、维护、保管而造成损坏的; 经本公司授权维修者以外人员拆动、改装造成损坏的; 因不可抗力 (如自然灾害、火灾、雷击、水) 造成损坏的; 非本公司产生的运输损害、过压、液体渗入、外观损坏、磨损老化等人为原因造成损坏的; 已超过保修期; 无保修卡及有效的购买发票、或购买发票与保修卡不符, 或购买发票被涂改或无法辨认均不提供保修服务, 但本公司及本公司授权维修站可按相关规定实行收费维修。

### 保修服务仅在中华人民共和国大陆地区有效。

由于汽车音响产品的安装属性, 产品发生故障后, 消费者必须先联系本产品最初的授权安装点检查并排除非产品质量原因导致的故障。无论是何产品质量原因还是非质量原因导致的所有故障, 均应由授权安装点负责: 拆卸故障产品、送交授权维修站、装回产品的工作。

本公司不负责任何由于汽车音响产品损坏或故障而直接或间接导致的其他损失。

### 产品中有害物质的名称及含量

部件名称	目标部件	有害物质或元素					
		铅 (Pb)	汞 (Hg)	镉 (Cd)	六价铬 (Cr(VI))	多溴联苯 (PBB)	多溴二苯醚 (PBDE)
箱体	外壳, 面板, 背板等	x	o	o	o	o	o
电路板	印刷电路板, 电路板上的电子零件, 内部相关连接线	x	o	o	o	o	o
零部件	电容, 连接器等	x	o	o	o	o	o
附件	电源线, 说明书, 包装等	x	o	o	o	o	o

本表格依据 SJ/T 11364 的规定编制

o: 表示该有害物质在该部件所有均质材料中的含量均在 GB/T 26572 规定的限量要求以下。

x: 表示该有害物质至少在该部件的某一均质材料中的含量超出 GB/T 26572 规定的限量要求。



在中华人民共和国境内销售的电子电气产品上将印有“环保使用期”(EUP)符号。圆圈中的数字代表产品的正常环保使用年限。





HARMAN International Industries,  
Incorporated 8500 Balboa Boulevard,  
Northridge, CA 91329 USA  
<https://www.jbl.com/>

© 2020 HARMAN International Industries, Incorporated. All rights reserved.  
JBL is a trademark of HARMAN International Industries, Incorporated,  
registered in the United States and/or other countries.  
Features, specifications and appearance are subject to change without notice.