

HANDLE BAR CONTROL INTERFACE FOR 1998-2013 HARLEY DAVIDSON MOTORCYCLES

This HDSWC1 interface allows you to replace your factory original Harley Davidson stereo while retaining handle bar mounted controls (when equipped). The interface is designed for easy plug and play connection and NO cutting, splicing or adding additional resistors is required. The included harness also provides +12V Constant power, +12V Switched power and Front speaker connections.

APPLICATION GUIDE

HARLEY DAVIDSON:

ROAD GLIDE/FLTR	1998-2013
STREET GLIDE/FLHX/FLHT	1998-2013

FEATURES

- Retains handle bar control controls (If equipped)
- Retains OEM phone buttons (if aftermarket stereo supports)

LIABILITY DISCLAIMER

This HDSWC1 instruction manual is based on carefully documented data and research. Scosche Industries Inc. cannot be held responsible for discrepancies/inconsistencies that may occur due to the vehicle manufacturing changes or options, or damages that may occur in the vehicle during the installation of components while using this manual.

If you any further questions, call our toll-free technical help line at: 1-800-621-3695 x3

WIRE COLOR CODES

White = Left Front Positive (LF+)
White/Black = Left Front Negative (LF-)

Gray = Right Front Positive (RF+)
Gray/Black = Right Front Negative (RF-)

Black = Chassis Ground
Yellow = +12V Constant Power
Red = +12V Accessory

NOTE: The RED Accessory output wire from the HDSWC1 interface is rated at 10A Max output for most Aftermarket headunits. We do NOT recommend connecting additional +12V switched accessories to this output source as that may cause damage to the HDSWC1 module itself. If 10A output is not sufficient, then a relay is needed. (Relay not included)

STEERING WHEEL WIRING CODES

Alpine	Cut Green wire loop
Clarion	Cut Violet wire loop
JVC	Cut Green AND Violet loops
Panasonic	Cut Blue wire loop
Kenwood / JVC 2011 & Later	Cut Blue and Green loops
Sony/Pioneer	Do NOT cut loops

1. Prepare the HDSWC1 steering wheel connector harness using the chart above.
2. Connect the harness to the interface module.
3. For Alpine, Clarion, JVC, Panasonic and Sony Car Stereos, connect the 3.5MM male steering plug into the Steering wheel input jack at the back of the Stereo.
4. For Kenwood and newer JVC Stereos, connect the Blue wire from the Steering wheel harness to the "Remote in" wire at the back of the Stereo.

**TECH
SUPPORT !**

If you have any questions or need Technical Assistance with the installation, or the most current applications, please call (800) 621-3695 Ext. 3

Steering Wheel Controls

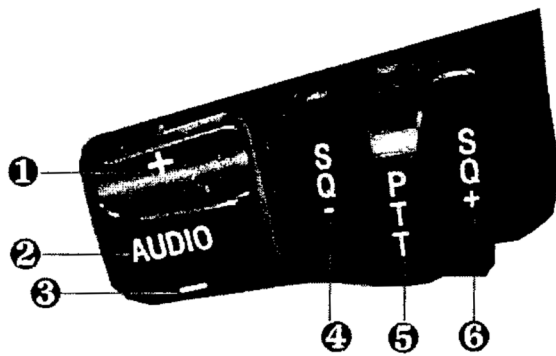

Left Handlebar Controls

1. Volume +
2. Mute
3. Volume -
4. End ((If equipped)
5. Preset + (If equipped)
6. Answer (If equipped)

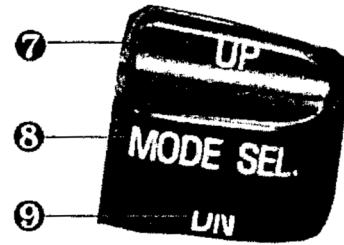

Right Handlebar Controls

7. Track +/Seek +
8. Source
9. Track -/seek -

Detach this page for customer use

HDSWC1 WIRING DIAGRAM

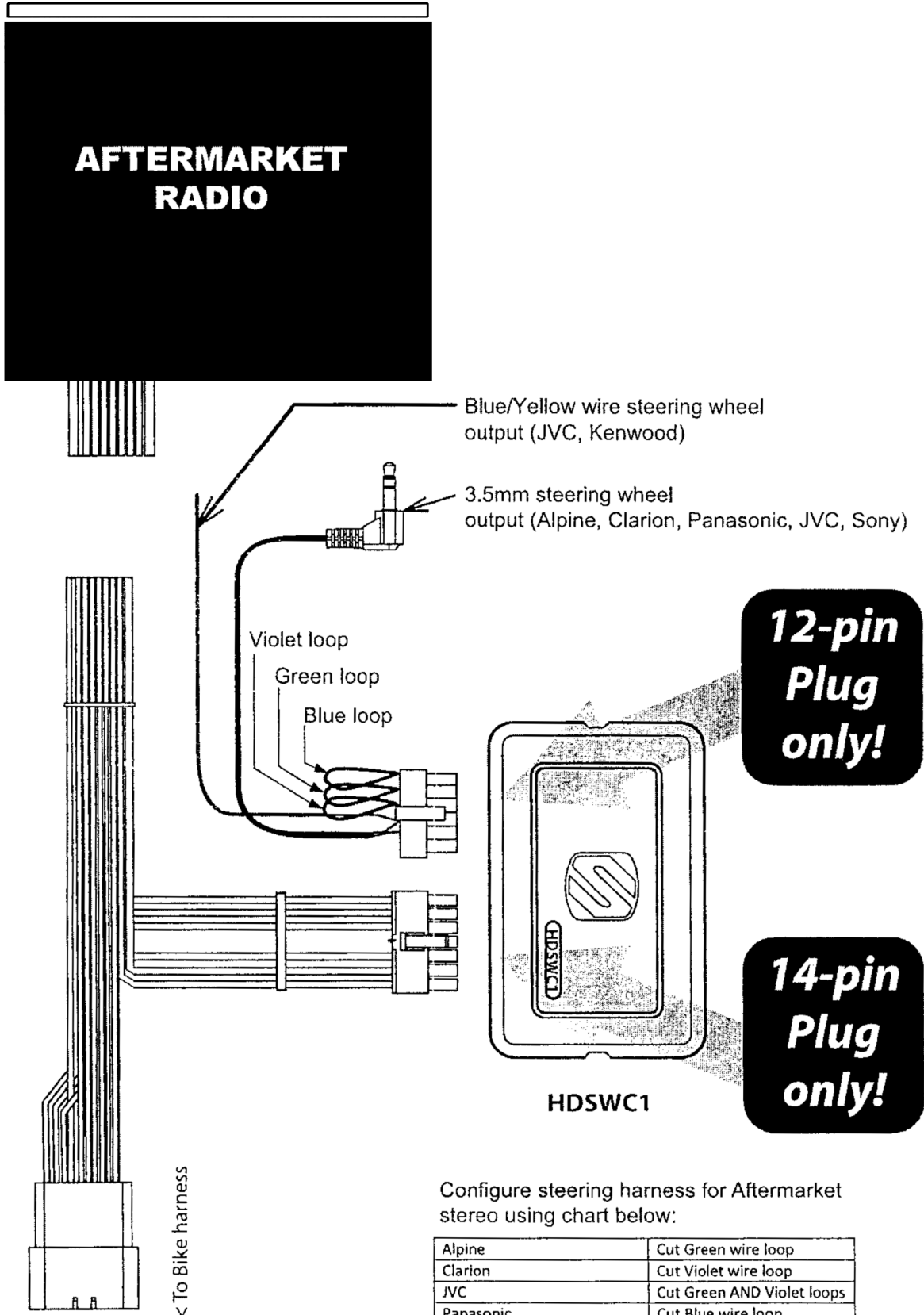

Configure steering harness for Aftermarket stereo using chart below:

Alpine	Cut Green wire loop
Clarion	Cut Violet wire loop
JVC	Cut Green AND Violet loops
Panasonic	Cut Blue wire loop
Kenwood / JVC 2011 & later	Cut Blue AND Green loops
Sony/Pioneer	Do NOT cut loops