



Rostra RearSight™ **250-8069/250-8085** **Installation Instructions**

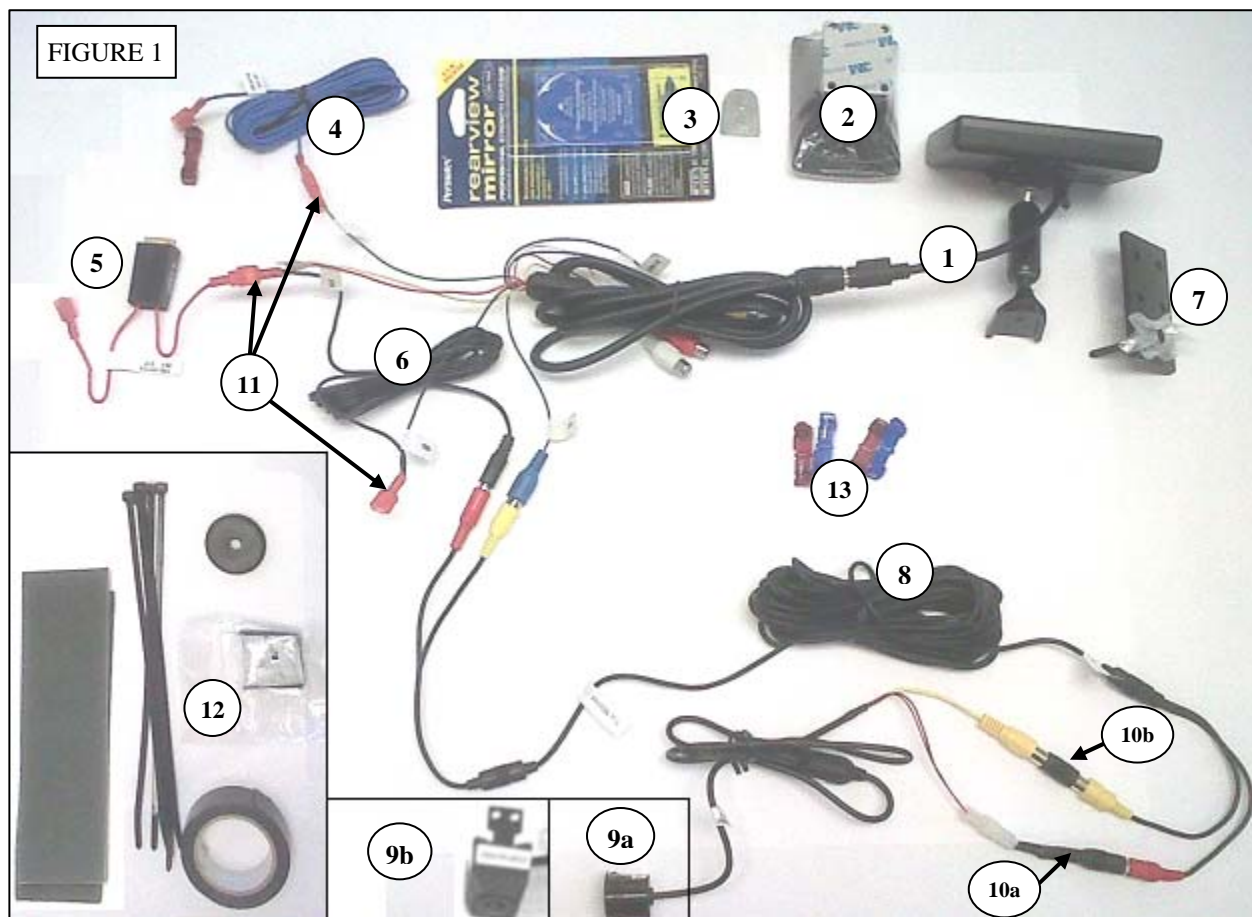

Table 1

ITEM	PART NAME	PART NUMBER	ITEM	PART NAME	PART NUMBER
1	Monitor & Stem Assembly	250-8118	9a	Tube Camera	250-8083
2	Dash Mount Bracket		9b	Bracket Camera	250-8082
3	Mirror Lug Mount & Glue		10a	RCA Male to Male	
4	Reverse Lead Extension		10b	DC Adapter	250-8562
5	Fuse Lead		11	Male Insulated Terminal	
6	DC Power Female		12	Miscellaneous Sack Parts	
7	Headliner Mount	250-8513	13	T-Tap Connectors 18-24	
8	30' Video Extension	250-8503			

MONITOR – WIND SHIELD MOUNT (FIGURE 2)

1. REMOVE VEHICLE MIRROR. (IF VEHICLE IS NOT EQUIPPED WITH REARVIEW MIRROR/WINDSHEILD LUG, USE LUG AND GLUE AS PER ITEM 3 IN **FIGURE 1**).
2. USE A TORX T-10 TO LOOSEN AND THEN TIGHTEN THE TENSIONING SCREW IN THE MIRROR STEM BASE TO FIX THE MONITOR TO THE WINDSHIELD LUG.

MONITOR – HEAD LINER MOUNT (FIGURE 3)

1. USE A TORX T-10 DRIVER TO REMOVE THE TENSIONING SCREW IN THE MIRROR STEM BASE. REPLACE THE TORX SCREW WITH THE 1-1/2" 8/32 SCREW IN THE SMALL PARTS PACKAGE. USE A PHILIPS DRIVER TO TIGHTEN SCREW SECURELY.
2. MAKE SURE THE MOUNTING POSITION HAS CLEARANCE FOR THE SCREW THROUGH THE HEADLINER SUCH THAT THE SCREW DOES NOT HIT THE ROOF OR ANY OBSTRUCTION THAT WILL HOLD THE HEADLINER OUT OF POSITION. PLACE ONE OF THE RECTANGULAR BLACK BRACKETS FROM THE SMALL PARTS PACKAGE IN POSITION ON THE HEADLINER. PUNCH A HOLE OR PUSH THE SCREW MOUNTED IN THE BASE OF THE MIRROR THROUGH THE HEADLINER. PLACE THE OTHER BRACKET OVER THE SCREW, FOLLOWED BY THE ORBITAL WASHERS, FLAT WASHER AND 8-32 NUT/WASHER.
3. VALIDATE THE STEM ASSEMBLY WILL NOT TWIST ON THE BRACKET. VALIDATE THE STEM CAN BE ADJUSTED AND NOT DAMAGE THE HEADLINER. (**FIGURE 4**)

TUBE CAMERA

1. CONNECT THE EXTENSION HARNESS TO THE CAMERA AS SHOWN IN **FIGURE 1 & 7**. LOCATE AN AREA ON THE BUMPER TO MOUNT CAMERA AT THE REAR OF VEHICLE. **NOTE: THIS CAMERA SHOULD BE MOUNTED IN A RESIN BUMPER ONLY.** MAKE SURE THE LOCATION IS ACCESSIBLE FROM THE INSIDE OF THE VEHICLE TO PROVIDE ACCESS TO THE EXTENSION HARNESS.
2. USE A 7/8" OR 22MM BIT TO DRILL A HOLE FOR THE CAMERA. **FIGURE 5.** BE SURE TO USE MASKING TAPE TO PROTECT THE DRILLING AREA OF THE BUMPER.

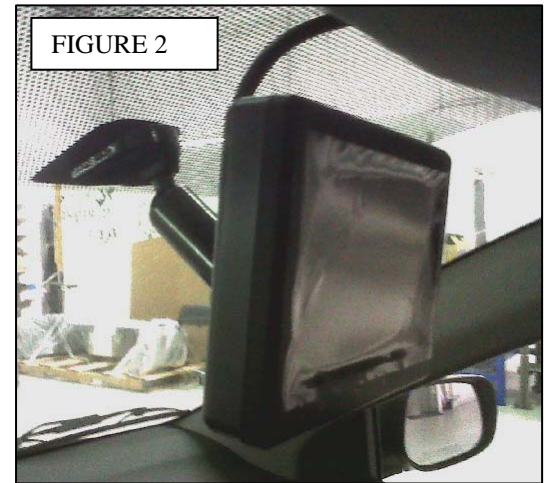

FIGURE 2



FIGURE 3



FIGURE 4

BRACKET CAMERA

1. LOCATE AN AREA TO MOUNT CAMERA AT THE REAR OF VEHICLE. MAKE SURE THE LOCATION IS ACCESSIBLE FROM THE INSIDE OF THE VEHICLE TO PROVIDE ACCESS TO THE EXTENSION HARNESS. CONNECT THE EXTENSION HARNESS TO THE CAMERA AS SHOWN IN **FIGURES 1 & 7**.
2. USING THE HARDWARE PROVIDED, MOUNT THE CAMERA SO THAT THE AREA VIEWED INCLUDES A MINOR PORTION OF THE BUMPER. **FIGURE 6**. THIS WILL PROVIDE DEPTH PERCEPTION FOR VIEWING AS THE VEHICLE IS DRIVEN IN REVERSE.

ELECTRICAL HOOK UP OF SYSTEM

1. STARTING AT THE MONITOR END, CONNECT THE ACC (RED), BAT (YELLOW) AND 12+ DC (ON ADAPTOR HARNESS, BLACK WITH STRIPE) INTO AN INSULATED MALE TERMINAL AND TO THE FUSE LINK. CONNECT THE GND (BLACK) AND GROUND (ON ADAPTOR HARNESS, PLAIN BLACK). FOR REVERSE POWER, TERMINATE THE BACK (LIGHT GREEN WIRE) USING AN INSULATED MALE TERMINAL. FIND AND CONNECT EACH CIRCUIT TO THE PRESCRIBED POINT ON THE VEHICLE USING THE SUPPLIED T-TAP CONNECTORS.
2. CONNECT THE RCA EXTENSION HARNESS AS SHOWN.
3. USE THE FOAM TAPE TO INSULATE AND SOUND PROOF UNUSED RCA CONNECTORS.

TROUBLESHOOTING

1. **MONITOR NOT WORKING**
WITH IGNITION
 - a. VERIFY IGNITION +12 VOLTS TO MONITOR ON POWER WIRES.
 - b. VERIFY GROUND TO MONITOR ON BLACK WIRE WITH MULTI-METER READING TO BE LESS THAN 10HM.
 - c. VERIFY MONITOR HARNESS IS FULLY PLUGGED INTO MONITOR.
2. **NO VIDEO**
WITH IGNITION ON, THE MIRROR MONITOR HAS NO PICTURE:
 - a. VERIFY EXTENSION HARNESS MATED TO MONITOR.
 - b. VERIFY HARNESSES ARE MATED PROPERLY AT CAMERA.
 - c. VERIFY POWER ON THE RED AND BLACK WIRES AT THE CAMERA.
 - d. VERIFY EXTENSION HARNESS IS NOT KINKED OR DAMAGED IN ROUTING PROCESS WITH CAMERA AND MONITOR EXTENSION ENDS UNPLUGGED VERIFY NO CONTINUITY BETWEEN INSIDE + AND - CIRCUITS BY TOUCHING OHM METER LEADS TO INSIDE POINT AND OUT SIDE POIT OF CABLE.
3. **NO REVERSE OVERRIDE**
 - a. CHECK REVERSE WIRE CONNECTION.
 - b. VERIFY REVERSE WIRE HAS +12 VOLTS AT BACK UP LIGHT CIRCUIT.

